

円を使った図形の面積

____年 ____組 名前 _____

■ 半円やおうぎ型、正方形を組み合わせてできている次の図形の面積を答えましょう。

①

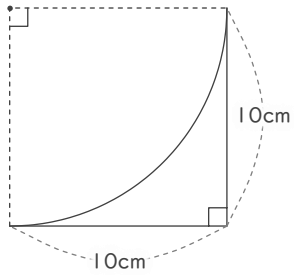

②

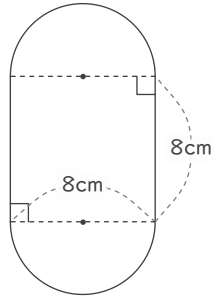

③

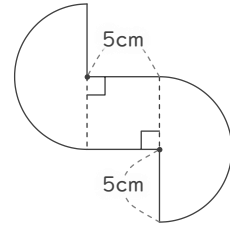

④

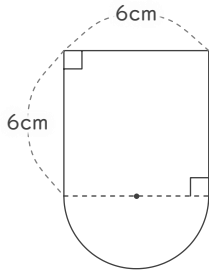

⑤

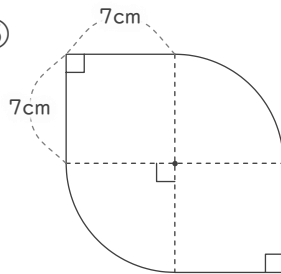

⑥

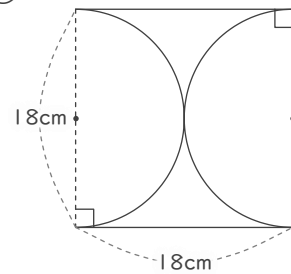

⑦

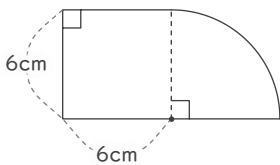

⑧

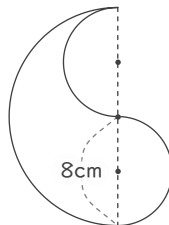

⑨

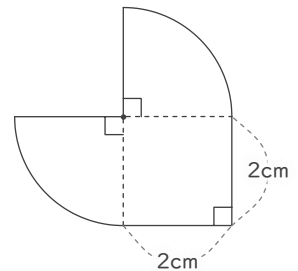

円を使った図形の面積

年 組 名前

19

■ 半円やおうぎ型、正方形を組み合わせてできている次の図形の面積を答えましょう。

①

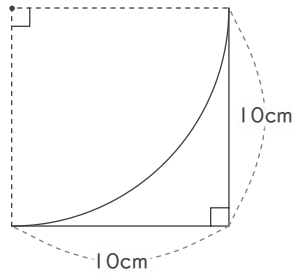

$$10 \times 10 = 100$$

$$10 \times 10 \times 3.14 \div 4 = 78.5$$

$$100 - 78.5 = 21.5$$

21.5cm²

②

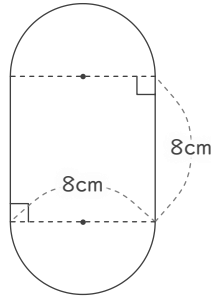

$$4 \times 4 \times 3.14 = 50.24$$

$$8 \times 8 = 64$$

$$50.24 + 64 = 114.24$$

114.24cm²

③

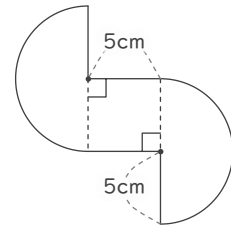

$$5 \times 5 \times 3.14 = 78.5$$

$$5 \times 5 = 25$$

$$78.5 + 25 = 103.5$$

103.5cm²

④

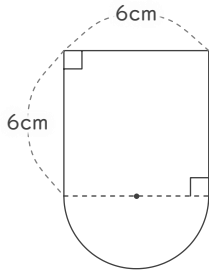

$$3 \times 3 \times 3.14 \div 2 = 14.13$$

$$6 \times 6 = 36$$

$$14.13 + 36 = 50.13$$

50.13cm²

⑤

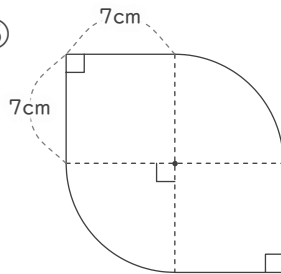

$$7 \times 7 \times 3.14 \div 2 = 76.93$$

$$7 \times 7 \times 2 = 98$$

$$76.93 + 98 = 174.93$$

174.93cm²

⑥

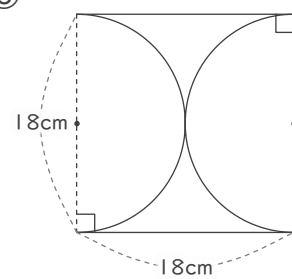

$$18 \times 18 = 324$$

$$9 \times 9 \times 3.14 = 254.34$$

$$324 - 254.34 = 69.66$$

69.66cm²

⑦

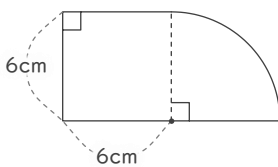

$$6 \times 6 \times 3.14 \div 4 = 28.26$$

$$6 \times 6 = 36$$

$$28.26 + 36 = 64.26$$

64.26cm²

⑧

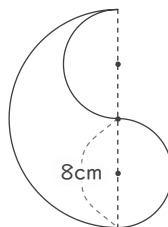

$$8 \times 8 \times 3.14 \div 2 = 100.48$$

100.48cm²

⑨

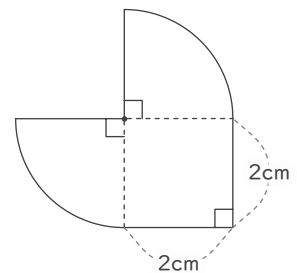

$$2 \times 2 \times 3.14 \div 2 = 6.28$$

$$2 \times 2 = 4$$

$$6.28 + 4 = 10.28$$

10.28cm²