

円を使った図形の面積

____年 ____組 名前 _____

■ 半円やおうぎ型、正方形を組み合わせてできている次の図形の面積を答えましょう。

①

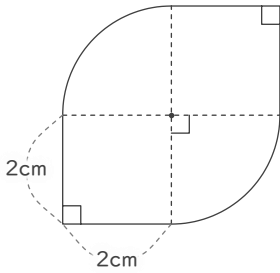

②

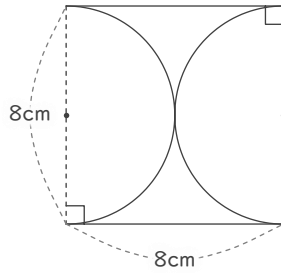

③

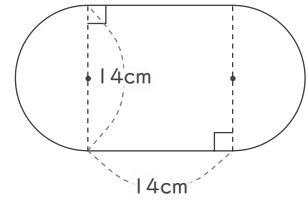

④

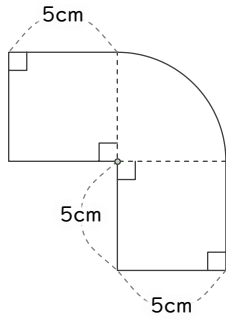

⑤

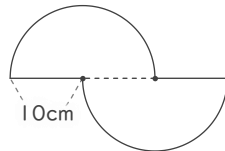

⑥

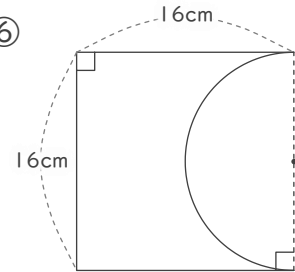

⑦

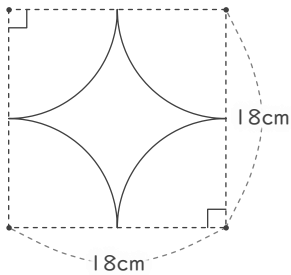

⑧

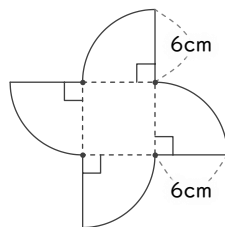

⑨

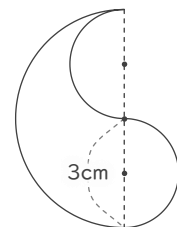

円を使った図形の面積

年 組 名前

19

■ 半円やおうぎ型、正方形を組み合わせてできている次の図形の面積を答えましょう。

①

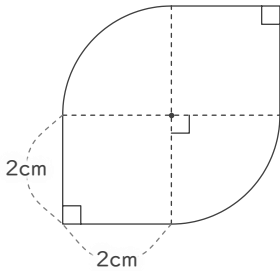

$$2 \times 2 \times 3.14 \div 2 = 6.28$$

$$2 \times 2 \times 2 = 8$$

$$6.28 + 8 = 14.28$$

14.28cm²

②

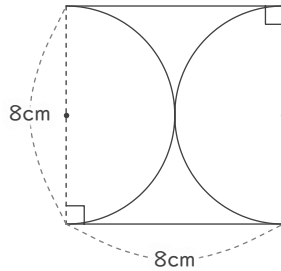

$$8 \times 8 = 64$$

$$4 \times 4 \times 3.14 = 50.24$$

$$64 - 50.24 = 13.76$$

13.76cm²

③

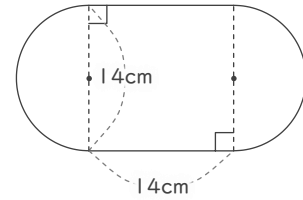

$$7 \times 7 \times 3.14 = 153.86$$

$$14 \times 14 = 196$$

$$153.86 + 196 = 349.86$$

349.86cm²

④

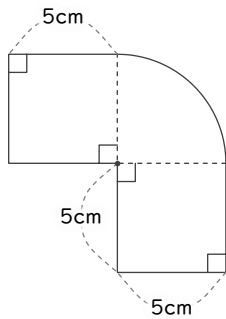

$$5 \times 5 \times 3.14 \div 4 = 19.625$$

$$5 \times 5 \times 2 = 50$$

$$19.625 + 50 = 69.625$$

69.625cm²

⑤

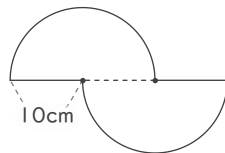

$$10 \times 10 \times 3.14 = 314$$

314cm²

⑥

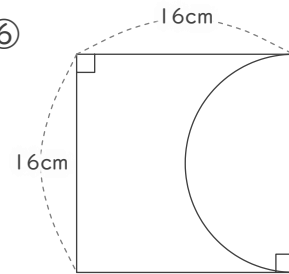

$$16 \times 16 = 256$$

$$8 \times 8 \times 3.14 \div 2 = 100.48$$

$$256 - 100.48 = 155.52$$

155.52cm²

⑦

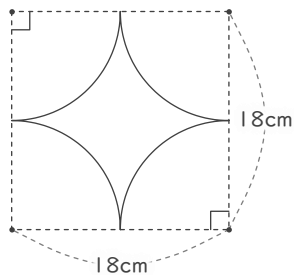

$$18 \times 18 = 324$$

$$9 \times 9 \times 3.14 = 254.34$$

$$324 - 254.34 = 69.66$$

69.66cm²

⑧

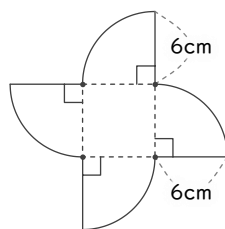

$$6 \times 6 \times 3.14 = 113.04$$

$$6 \times 6 = 36$$

$$113.04 + 36 = 149.04$$

149.04cm²

⑨

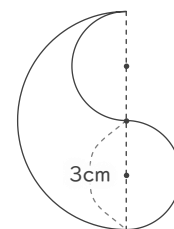

$$3 \times 3 \times 3.14 \div 2 = 14.13$$

14.13cm²