

■ つぎの おうぎ形 のまわりの長さを求めましょう。

①

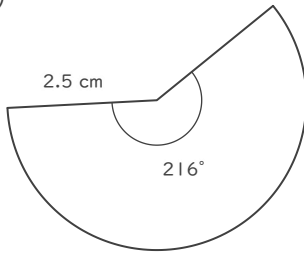

(式)

②

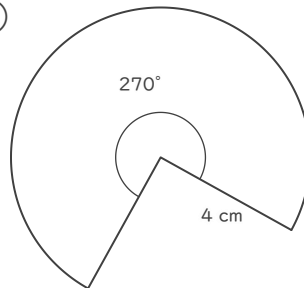

(式)

③

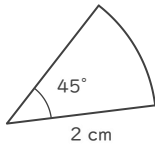

(式)

④

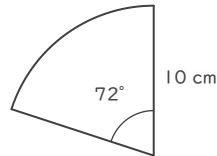

(式)

⑤

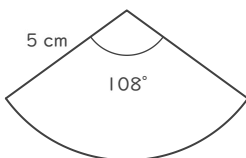

(式)

⑥

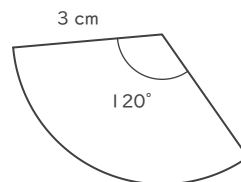

(式)

■ つぎの おうぎ形 のまわりの長さを求めましょう。

①

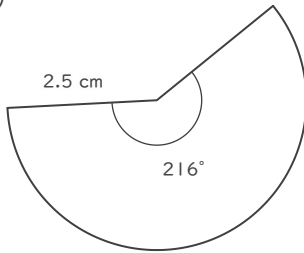

(式) $(2.5 \times 2) \times 3.14 = 15.7$

$15.7 \times 216 \div 360 = 9.42$

$9.42 + 2.5 \times 2 = 14.42$ 14.42 cm

②

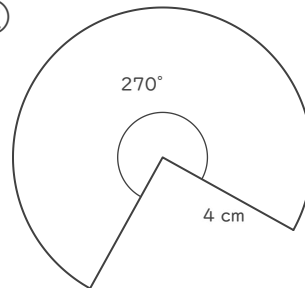

(式) $(4 \times 2) \times 3.14 = 25.12$

$25.12 \times 270 \div 360 = 18.84$

$18.84 + 4 \times 2 = 26.84$ 26.84 cm

③

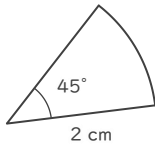

(式) $(2 \times 2) \times 3.14 = 12.56$

$12.56 \times 45 \div 360 = 1.57$

$1.57 + 2 \times 2 = 5.57$ 5.57 cm

④

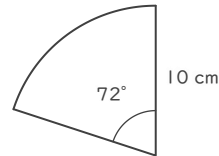

(式) $(10 \times 2) \times 3.14 = 62.8$

$62.8 \times 72 \div 360 = 12.56$

$12.56 + 10 \times 2 = 32.56$ 32.56 cm

⑤

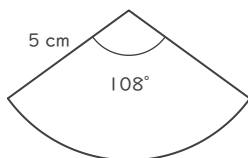

(式) $(5 \times 2) \times 3.14 = 31.4$

$31.4 \times 108 \div 360 = 9.42$

$9.42 + 5 \times 2 = 19.42$ 19.42 cm

⑥

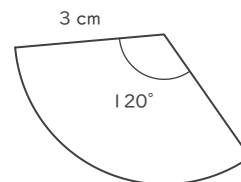

(式) $(3 \times 2) \times 3.14 = 18.84$

$18.84 \times 120 \div 360 = 6.28$

$6.28 + 3 \times 2 = 12.28$ 12.28 cm